



KULLEN 32 TBP

GENERAL

Type: Tug
 Built: 1976, Zaandam Holland
 Class: Lloyd's Register 100 A1 LMC, Ice Class 1A
 Flag: Swedish
 Dimensions O.A (draft): L 27,50m, B 8,13m , D 3,96m
 GRT: 228
 IMO number: 7527875
 Call sign: SDHF
 Port of registry: Helsingborg

PERFORMANCE

Speed free running: 12,5 knots
 Bollard pull: 32 ton

PROPULSION

Main engines: Nohab Polar Diesel engines
 Total power: 2640 BHP (1940kW)
 Bow thruster: Yes
 Propellers: Seffle C/P

AUXILIARY EQUIPMENT

Main generator sets: 2 pcs
 Capacity: 2x104kw
 Hydraulic set: 208Kw

TANK CAPACITIES

Fuel oil: 60 m3
 Dirty oil: 2x700l
 Fresh Water: 9,5 m3
 Lube oil: 1 m3
 Sewage: 4 m3

DECK

Deck Crane: 1 ton at 3m
 AH/Towing winch: 1x23 ton / 600m

NAVIGATION EQUIPMENT

Satellite compass, RADAR (2 pcs), Autopilot, AIS, Echosounder, VHF/DSC (2 pcs), Handheld VHF (3 pcs), Navtex, Transas ECDIS Navigation, Magnetic compass

ACCOMMODATION

Heated and air-conditioned living spaces for seven persons, consisting of 3 single crew cabins and two double crew cabins, a galley/mess and sanitary facilities.

Details believed to be correct but not guaranteed and can be subject to change.

BTÖ
 ett företag i MarCon gruppen

**For contact details please visit
 our website www.soundtug.se**

SIDE VIEW

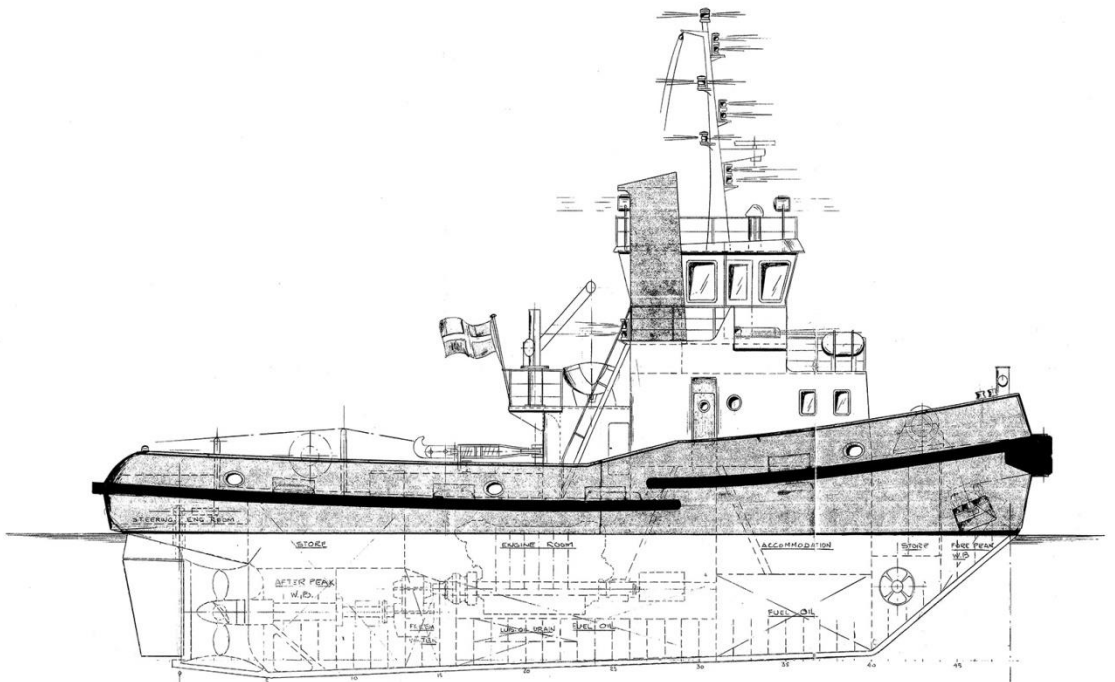

MAINDECK

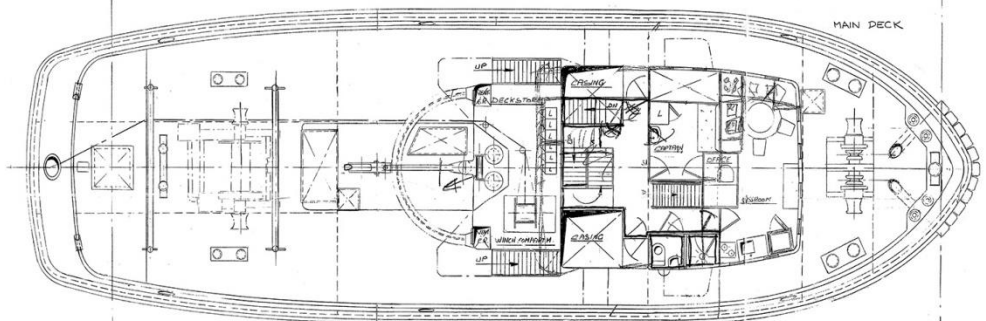

BELOW MAINDECK

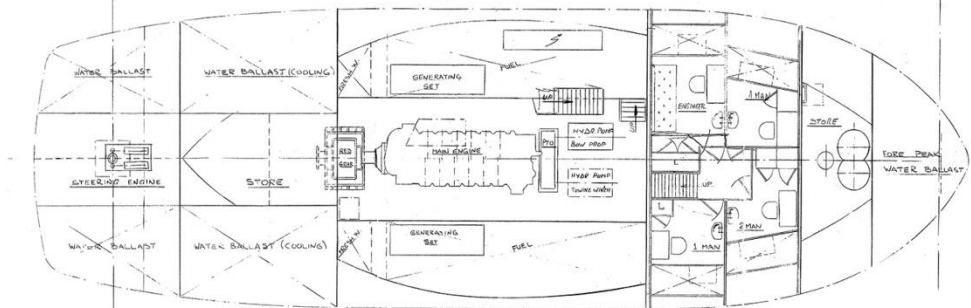

Details believed to be correct but not guaranteed and can be subject to change.



KULLEN 32 TBP

**For contact details please visit
our website www.soundtug.se**